

PROJECT NO.	06934	
DESIGNED	PEB	
DRAWN	MKL, RK	
CHECKED	PEB	
DATE	FEBRUARY 22, 2010	
REVISIONS		
NO.	DATE	DESCRIPTION

SHEET TITLE	PROPOSED LEASE EXHIBIT PLAN
SHEET NO.	LP-1
SEQUENCE	01 OF 01

BUILDING DATA

BLDG. I	SUITE	TENANT	SQUARE FEET
	301	ALABAMA POWER CREDIT UNION	2,208 SF
	305	TCBY	1,600 SF
	308-313	JOHNNY RAY'S	3,200 SF
	317	SUBWAY	1,600 SF
	321-329	AVAILABLE	4,800 SF
	333	TOP NAILS	1,600 SF
	337-341	COSMETOLOGY SCHOOL	3,200 SF
	345	CHINESE	1,600 SF
	349	ENGLISH IVY	2,200 SF

BLDG. II	SUITE	TENANT	SQUARE FEET
	377	DR. GREGORY TENN	1,600 SF
	381-385	SIPS 'N STROKES	3,200 SF
	389	DR. SHANNON (FAMILY DENTISTRY)	1,600 SF
		TOTAL SF SHOPS	28,408 SF
	365	TOTAL SF PUBLIX	45,600 SF
		TOTAL SF	74,008 SF

LEASE EXHIBIT BASED ON INFORMATION AS PROVIDED BY THE OWNER

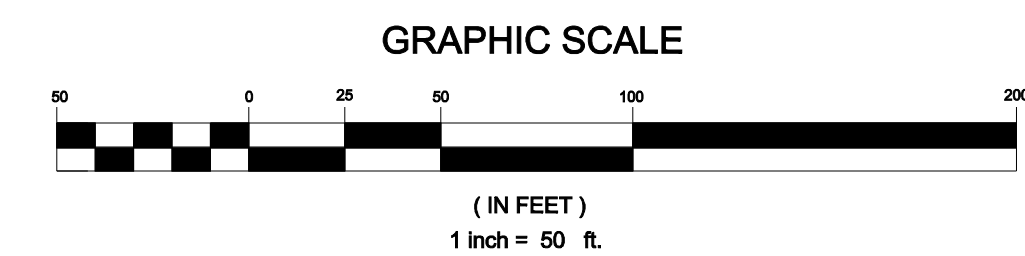

KREBS ARCHITECTURE & ENGINEERING, INC.
2100 RIVER HAVEN DRIVE
SUITE 100
BIRMINGHAM, AL 35244
205-987-7411 P
205-987-7415 F
KrebsAE.com

KREBS ARCHITECTURE & ENGINEERING, INC.
2100 RIVER HAVEN DRIVE
SUITE 100
BIRMINGHAM, AL 35244
205-987-7411 P
205-987-7415 F
KrebsAE.com

KREBS ARCHITECTURE & ENGINEERING, INC.
2100 RIVER HAVEN DRIVE
SUITE 100
BIRMINGHAM, AL 35244
205-987-7411 P
205-987-7415 F
KrebsAE.com

CLAYTON'S ADDITION TO OAK MOUNTAIN BUSINESS PARK

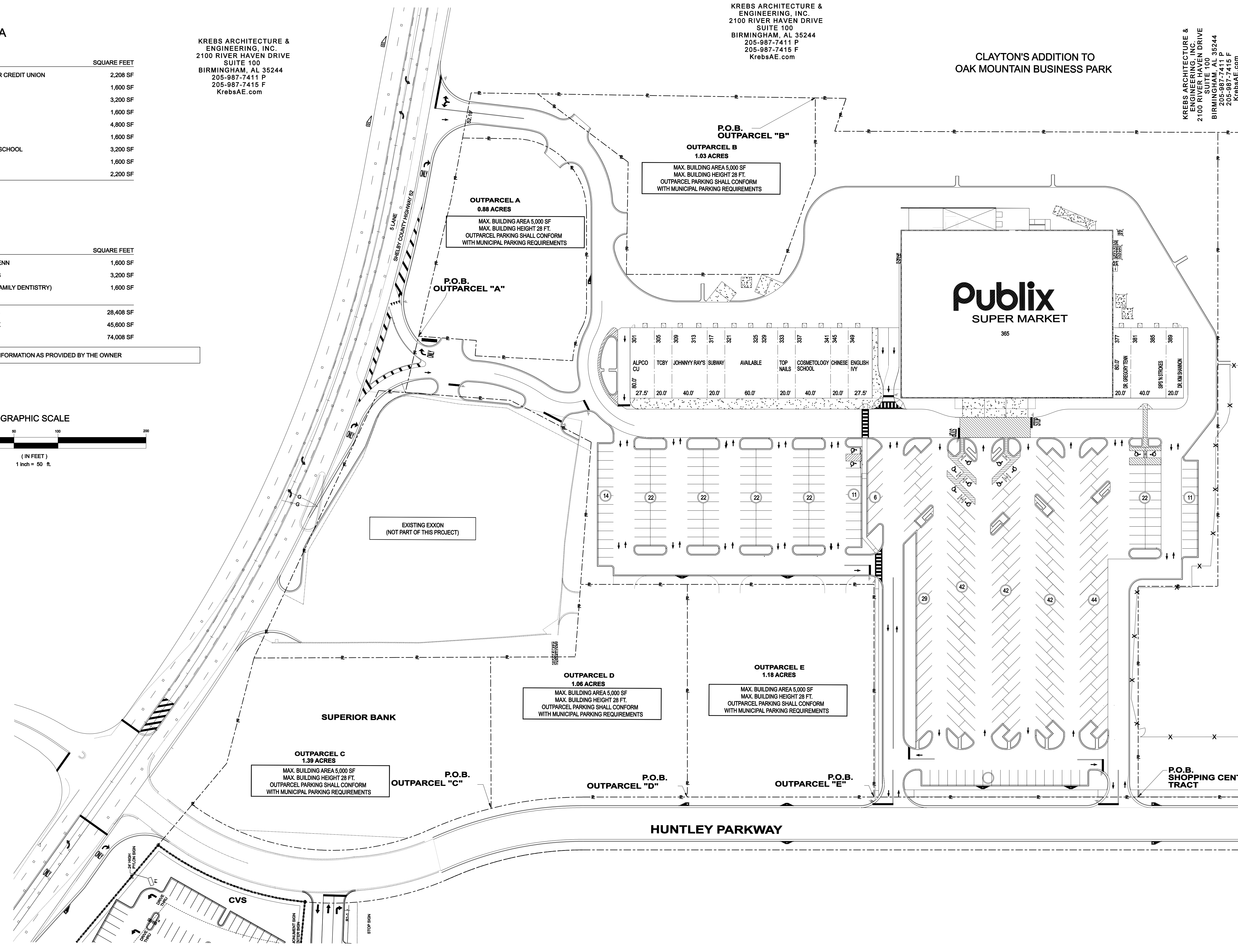

PAR:06934
2/22/2010
11:06:02 AM
C:\Users\mkrebs\Documents\06934\LP-1-022210.dwg