

**ENDCAP 4,000 SF + 1,400 SF & 7,300 SF AVAILABLE**

# **NORTHPORT CORNERS**

**1700 - 1800 McFarland Blvd  
Northport, Alabama 35476**



Endcap 4,000 SF - Suite 1848,  
1,400 SF - Suite 1820 & 7,300  
SF- Suite 1800 available!  
These spaces are a great  
location and in a high traffic  
corner shopping center. This  
center is anchored by a  
Walmart Neighborhood  
Market Store with Harbor  
Freight Tools. This is a rare  
vacancy in 100% leased



**For More Leasing Information Contact**

**Sam Sharp: [ssharp@sharprealty.com](mailto:ssharp@sharprealty.com) / (205) 879-1995 Ext. 2**

*No warranty or representation expressed or implied has been made as to the accuracy of the information provided herein and no liability is assumed for errors or omissions.*



400 Union Hill  
Suite 300  
Birmingham, AL 35209

Toll Free 866.870.1995  
Phone 205.879.1995  
Fax 205.879.1908  
Web [www.sharprealty.com](http://www.sharprealty.com)

# NORTHPORT CORNERS

Northport, Alabama

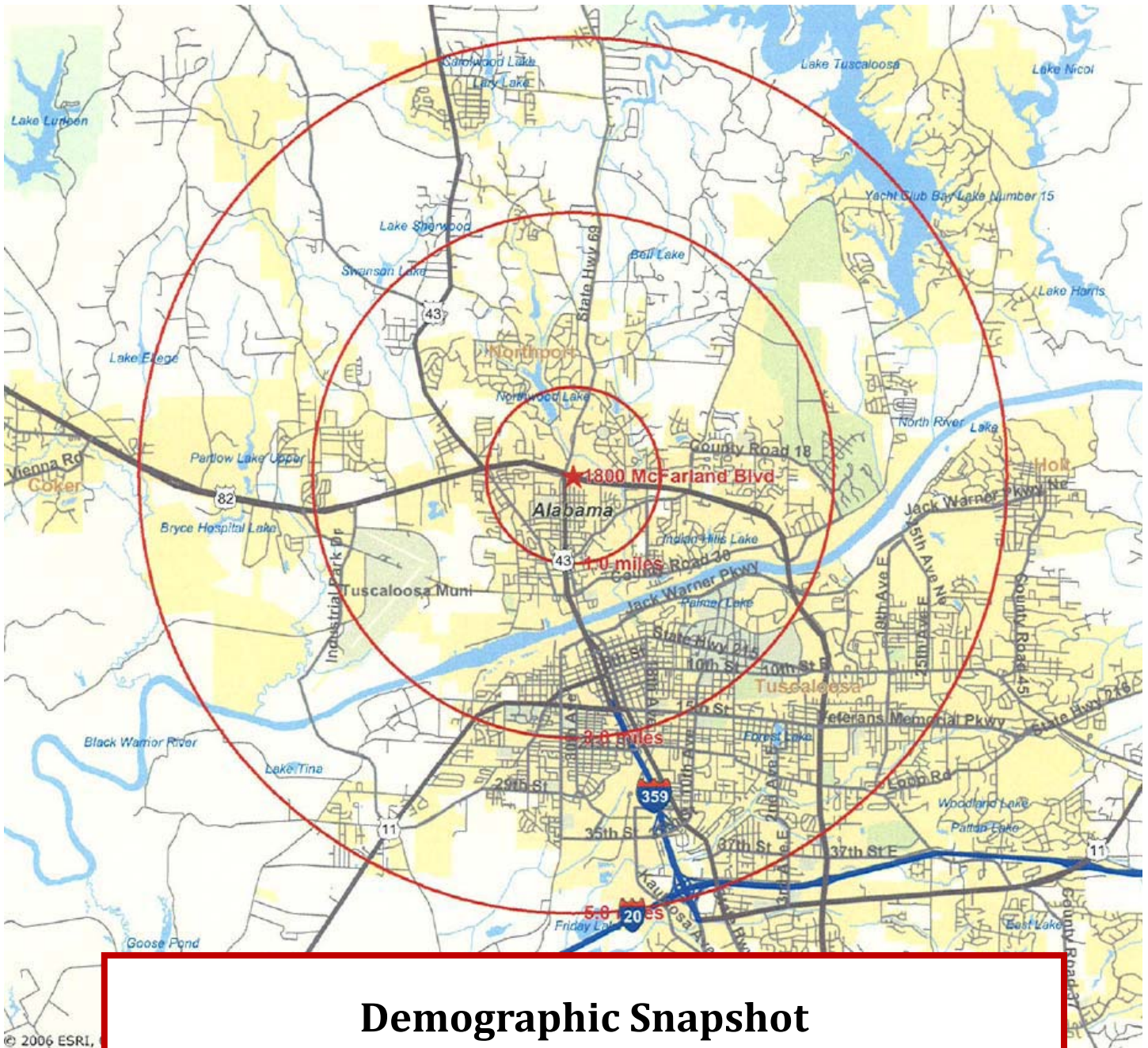

## Demographic Snapshot

	1 Mile	3 Mile	5 mile
<b>Population</b>	5,844	37,807	81,362
<b>Households</b>	2,459	15,624	33,507
<b>Average Household Income</b>	\$46,096	\$43,791	\$43,240

**SHARP**

Realty & Management LLC

400 Union Hill  
Suite 300  
Birmingham, AL 35209

Toll Free 866.870.1995  
Phone 205.879.1995  
Fax 205.879.1908  
Web [www.sharprealty.com](http://www.sharprealty.com)

# NORTHPORT CORNERS

Northport, Alabama 35476



# NORTHPORT CORNERS

## SITE PLAN

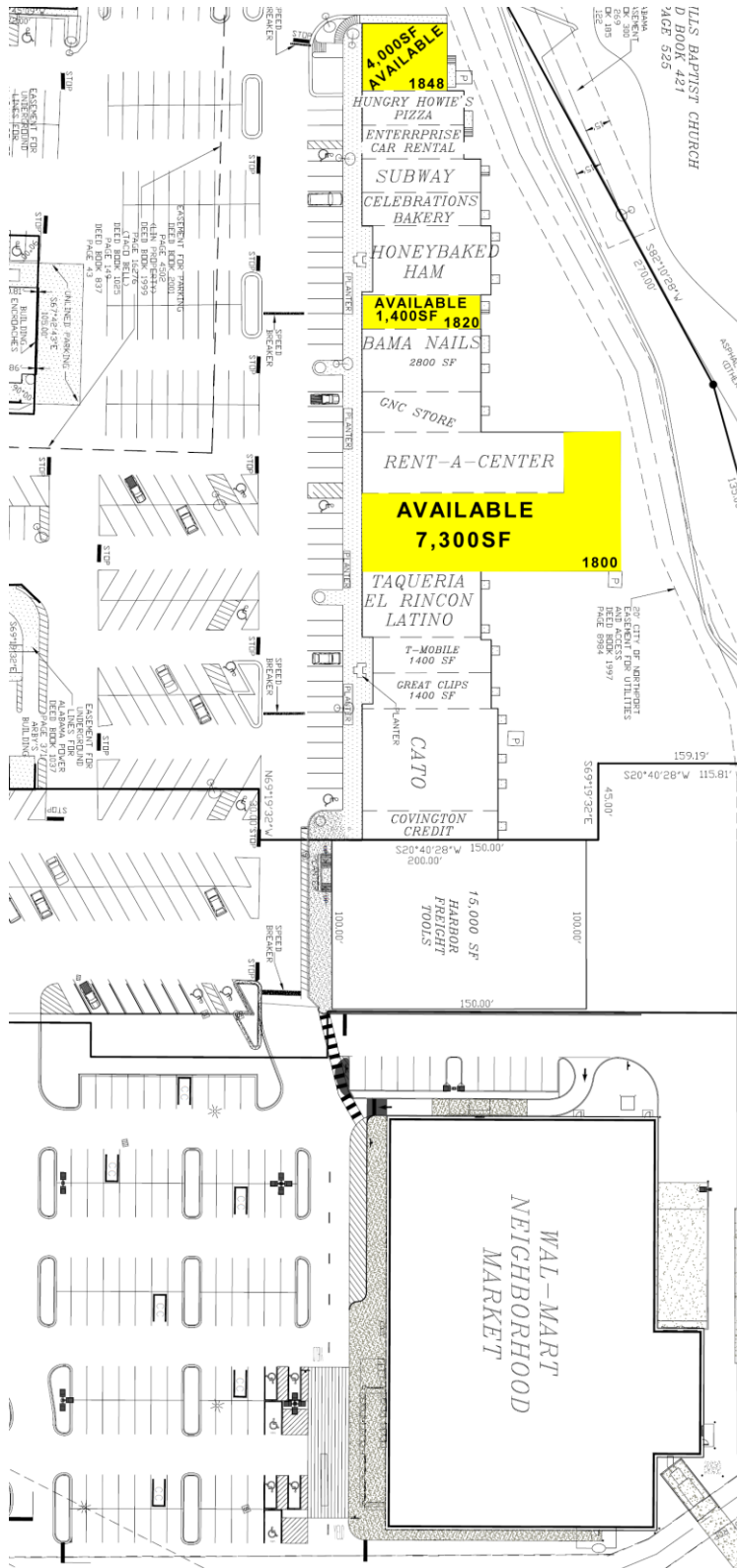

400 Union Hill  
 Suite 300  
 Birmingham, AL 35209

Toll Free 866.870.1995  
 Phone 205.879.1995  
 Fax 205.879.1908  
 Web [www.sharprealty.com](http://www.sharprealty.com)

# NORTHPORT CORNERS

Northport, Alabama 35476

**ENDCAP 4000SF - Suite 1848**

